



NORTH

**LA PAZ, ILOILO CITY  
WVSU MAIN CAMPUS PROPOSED  
SITE DEVELOPMENT PLAN**

1  
SCALE 1:10000000

EXISTING 3 X 187 KVA UT  
TO BE TRANSFERRED TO  
NEW LOCATION

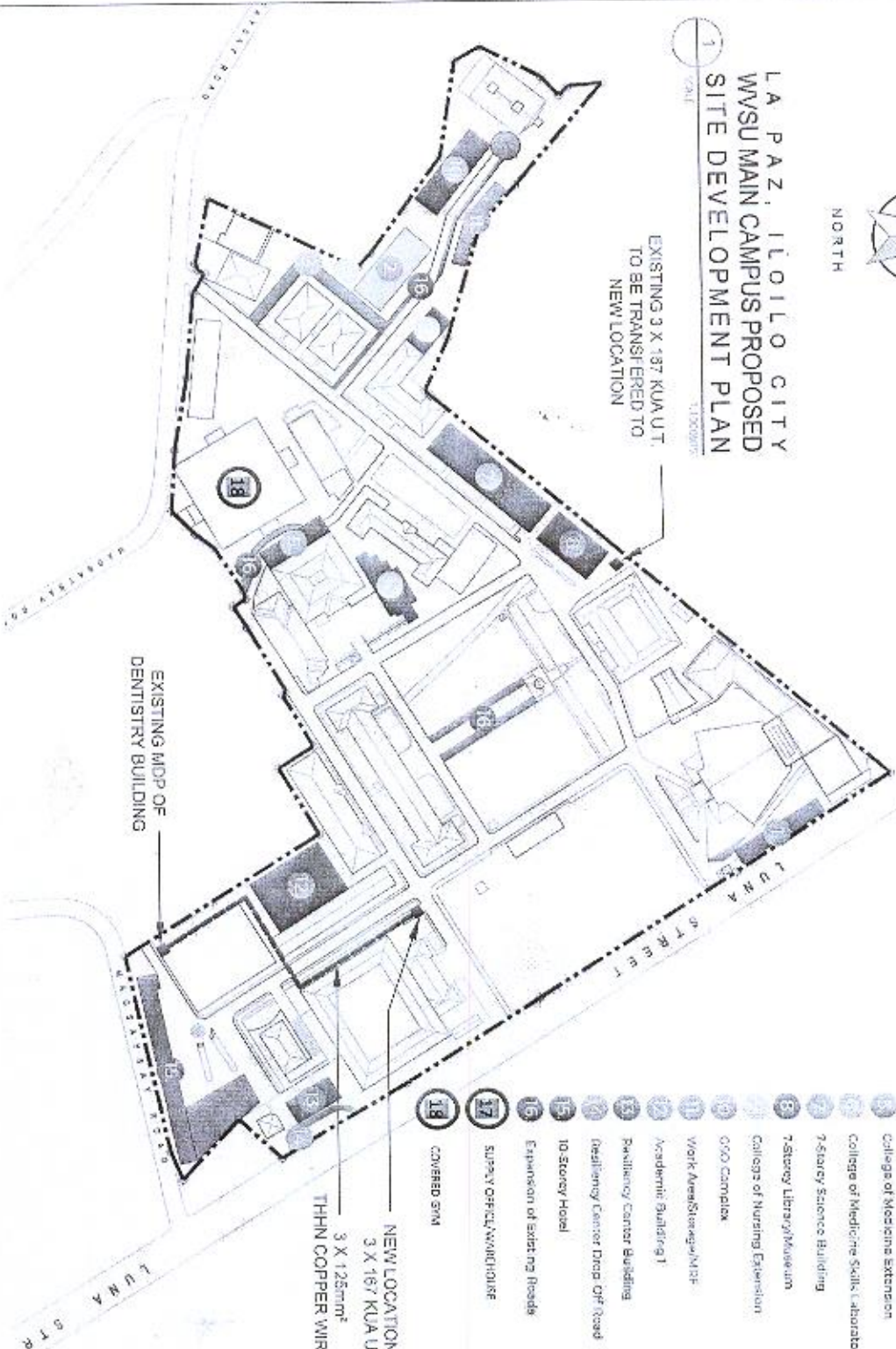

- 18 Covered S/M
- 17 Supply Office/Warehouse
- 16 Expansion of existing roads
- 15 10-Storey Hotel
- 14 Healthiness Center Drop Off Road
- 13 Healthiness Center Building
- 12 Academic Building 1
- 11 Work Area/Storage/Shop
- 10 OVO Complex
- 9 College of Nursing Extension
- 8 7-Storey Library/Museum
- 7 7-Storey Science Building
- 6 College of Medicine Skills Laboratory Building
- 5 College of Medicine extension
- 4 Dormitory Plaza
- 3 Dormitory Access Road
- 2 Dormitory
- 1 Commercial Building

NEW LOCATION OF  
3 X 187 KVA UT.  
THHN COPPER WIRE

EXISTING MIDP OF  
DENTISTRY BUILDING

VICINITY MAP

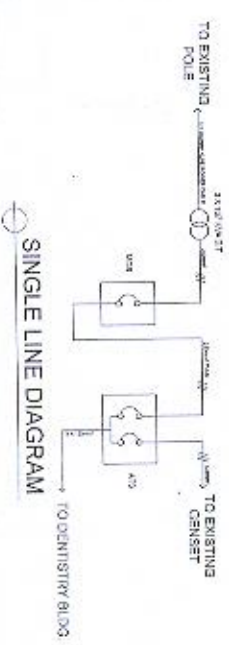
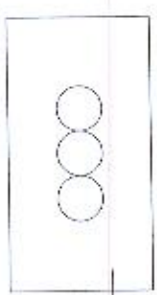

|  |  |  |   |                    |
|--|--|--|---|--------------------|
| PREPARED BY<br><br>AS. GERARDO L. BERNAL, JR.<br>ELECTRICAL ENGINEER<br>REG. NO. 100000000 | PROJECT TITLE<br><b>PROPOSED SUBSTATION &amp; FEEDER FOR DENTISTRY BLDG.</b><br>ILLUSTRATION: MGMT. PLAN/GENERAL ARRANGEMENT PLAN/CONCEPTUAL LAYOUT CITY | CHECKED BY<br><br>WILHELM P. CRIBAS, B.S.<br>ELECTRICAL ENGINEER<br>REG. NO. 100000000 | APPROVED BY<br><br>JONATHAN P. VILLARICA, M.D., PhD., FRCGS<br>SVP - FACILITIES | DATE<br>10/20/2023 |
|--|--|--|---|--------------------|